

USER MANUAL

READ ME

ENG

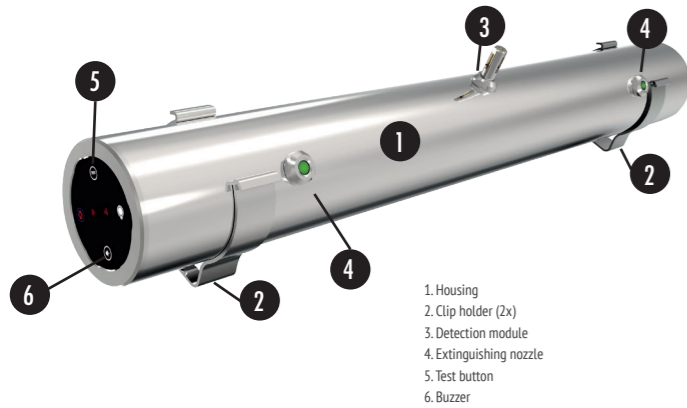

- 1. Housing
- 2. Clip holder (2x)
- 3. Detection module
- 4. Extinguishing nozzle
- 5. Test button
- 6. Buzzer



Time to be an EXPERT!



Dear Customer,
Thank you for purchasing the firetubeX® fully automatic fire suppression device.
The operating instructions will help you discover the diverse applications offered by the appliance and enjoy your new product, being safer.
Read through the operating instructions carefully. This helps avoid personal injury and material damage. Store the operating instructions carefully. If you pass on the appliance, include the operating instructions with it.
protecfire accepts no liability for damage caused by failure to observe the operating instructions.
If you require further information or have any questions on the appliance, contact protecfire or visit our website at: www.firetubeX.com
We hope you enjoy using your firetubeX!



Attention!

The firetubeX device cannot replace legally demanded fire protection or warning systems.

Make sure that the local statutory fire protection regulations are observed.

This is a personal choice for extra protection.

The firetubeX is a high-quality device engineered to protect people and their immediate surroundings. During assembly, make sure that the device is handled properly.
Commissioning may only be carried out in accordance with the enclosed operating instructions. If the operating instructions are not available, they are available in PDF format at: www.firetubeX.com.
There must be no flammable objects in the area of the hob or the danger area that would encourage the fire to spread. It must be ensured that the extinguishing nozzle of the system is free from contamination. Do not clean the sensitive glass ampoule in the detection module with sharp, hard objects.
It is important to ensure that there is no heat emitting light sources in the detection area. Excessive heat radiation can lead to false activations.

TABLE OF CONTENTS

1. Guarantee Conditions.....	3
2. Description and Function.....	4
3. Installation Guide.....	4-5
4. In case of Activation.....	4-5
5. Extinguishing Agent Specifications.....	7
6. After Activation.....	7
7. Disposal.....	7
8. Commissioning.....	7-8
9. Cleaning and Care.....	8
10. Technical Specifications.....	8
11. Warnings and limitations of liability.....	8

1. GUARANTEE CONDITIONS

In respect of new appliances ("Products") bought from a dealer authorised by us to sell such Products due to its expertise, we provide you with a manufacturer's guarantee based on the following conditions:
1.1. Private Use: the guarantee is for a period of 2 years. Where you purchased the Product in-store from an authorised retailer, the guarantee period shall commence at the point you purchased the Product. If you purchased the Product online from an authorised retailer, the guarantee period shall commence at the point the Product is delivered to you.
1.2. Commercial Use: the Products were designed and built for use in private households.
Exercise of your rights under this guarantee, and our subsequent performance of any repair work or supply of a replacement Product lead neither to an extension of the guarantee period nor to a new beginning of the guarantee period for the Product or installed spare parts.
1.3. a. To qualify for the benefit of this guarantee:
I. the Product must be shown (within 2 years of its purchase) to have failed to perform its normal function;
II. the said failure must be shown to result from defective workmanship or materials, including working parts;
III. the Product must have been packaged for transit to us with sufficient care to avoid all reasonably foreseeable damage or loss;
IV. you must provide proof of date of purchase (by way of a valid purchase receipt); and
V. the Product must have been supplied, maintained and used in accordance with the relevant Product instructions.
1.3.b. Subject to paragraph 1.2.a above, within the guarantee period we will correct all Product defects that are based on material or manufacturing errors, through repair or replacement of the Product.
Replaced parts become the property of protecfire. Protecfire may replace, at your request, certain components of the Product or provide updates which applies to the Product where such components are revised or updated, unless you contact us (using the methods described below) to tell us that you do not wish to receive the revised components.
You may transfer our guarantee to a person who has acquired the Product from you.
However, we may require the person to whom the

guarantee is transferred to provide reasonable evidence that they are now the owner of the Product.
We accept no liability for damage or malfunctions resulting from non-compliance with these operating instructions and improper use.
This product does not replace any legal and demandatory certified fire fighting equipment demanded by local laws. Warranty and liability claims for personal injury and property damage is excluded if they can be traced back to one or more of the following causes:
• Improper use
• improper assembly, commissioning, operation and maintenance of the device
• failure to observe the instructions in the operating instructions regarding transport, storage, assembly, commissioning, operation, maintenance of the device
• unauthorized changes to the device
• disasters due to the effects of foreign bodies and force majeure
• Intended use also includes
• the observation of all information in these operating instructions
• compliance with inspection and cleaning.

After the box is open, this product is not returnable unless for guarantee purposes.

2. DESCRIPTION AND FUNCTION

FiretubeX is a fully automatic detection and extinguishing device, without pressure in the extinguishing agent compartment or energy dependency. Engineered for protection against grease fires in residential kitchens, motorhomes, boats or small compartments, never intended to replace legal demanded equipment.

ACTIVATION

At 57°C, thermal detection activates the device. This activation is followed by the perforation of an innocuous gas cartridge, resulting in the pressurization of the suppressant agent chamber and its release.
Fire suppression agents are automatically deployed if the trigger temperature of the system is reached during a fire. When a fire is detected, a warning signal is automatically activated.

WHERE CAN IT BE USED AND INSTALLED?

Since the suppressant agent also has excellent properties for solid class A fires, the system can also be used in other areas with a potential hazard. This can be in the domestic as well as in the commercial sector.
The risk assessment made by the user of the firetubeX device is important. The firetubeX device is intended to be installed above the respective fire hazard zone and aligned in such a way that it covers the hazard area. The system reliably detects an incipient fire and applies the extinguishing agent and fights the flames in its area of coverage.
The extinguishing agent used is environmentally friendly and biodegradable. FiretubeX is intended to be functional, easy to operate, fast to install and very durable.

DURABILITY

The firetubeX device is ready for use immediately after installation.
After the fire, the extinguishing agent can easily be wiped off with water and disposed of with household waste. The firetubeX device is maintenance-free for 60 months from the date of production. The "best before date" is indicated on the sticker. After an activation or after the expiration date, the firetubeX must be disposed. This is the only way to ensure that a functioning system is available in case of emergency.

TRANSPORT

Transport the appliance in the original packaging. This avoids damage in transit.
Before transporting the appliance, clean and check if the glass bulb in the detector is not broken and the nozzles are still in their original state.
In transit, temperatures must be below 50°C to insure the device doesn't activate by temperature.

3. INSTALLATION GUIDE

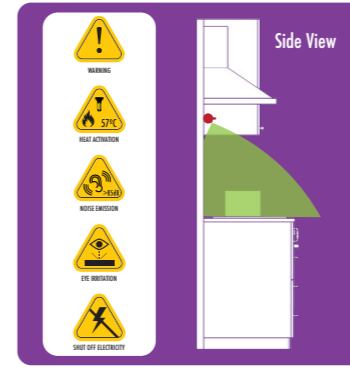
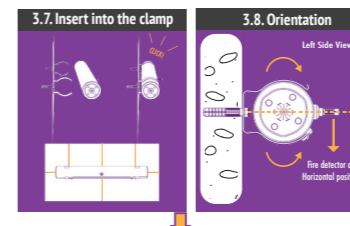
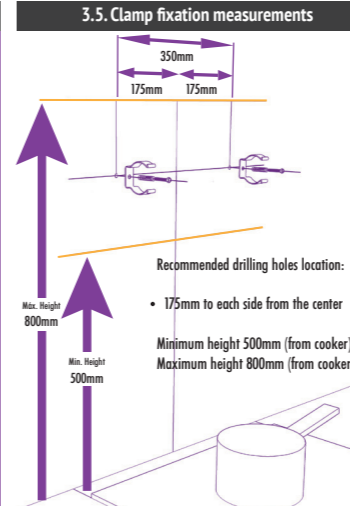
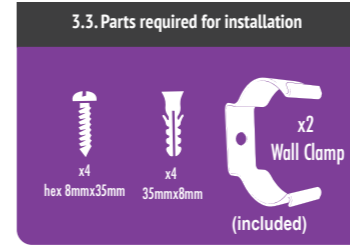
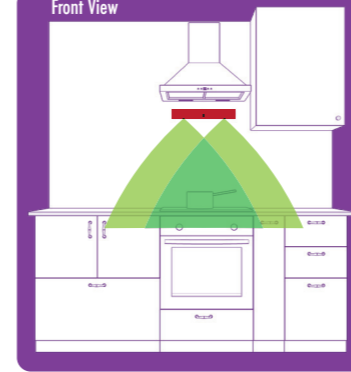
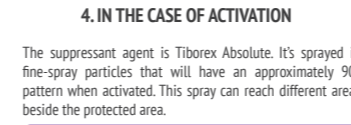
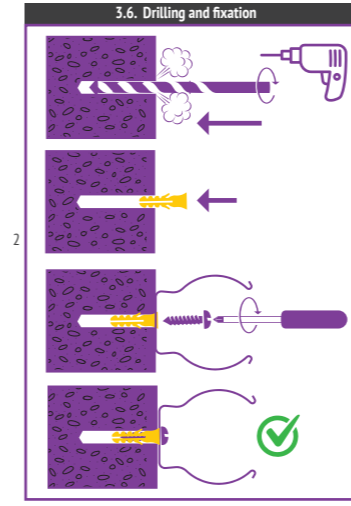
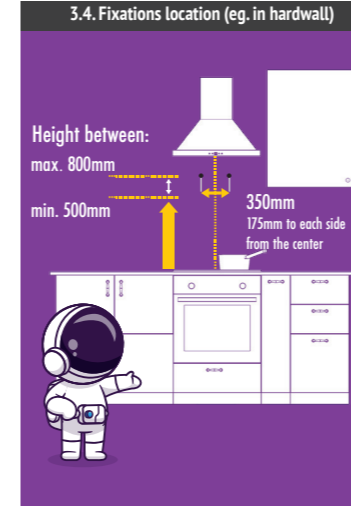
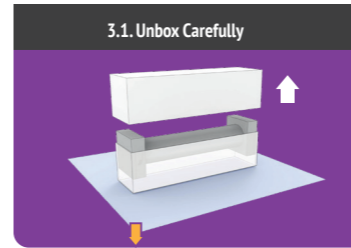

5. EXTINGUISHING AGENT SPECIFICATIONS
Manufacturer / Brand owner: Protecfire Engineering Pte Ltd
Country of manufacture: China, design in Germany
DESCRIPTION
TiboRex Absolute is a ready-to-use liquid special extinguishing agent without the addition of fluorocarbons for highly effective extinguishing of solid fires (class A fire), liquids, non-polar hydrocarbons (class B fire) and edible fats and oils. The special formulation, whose main components are also used as food additives, ensures exceptional extinguishing performance with unprecedented environmental protection.

APPLICATIONS
TiboRex Absolute is used undiluted and has been specially formulated for use in extinguishing systems and components developed by protecfire, which have been developed, tested and approved for specific purposes.

CERTIFICATIONS
TiboRex Absolute is tested and approved by MPA Dresden GmbH according to the requirements of DIN EN 1568 and DIN EN 3 in Germany.

STORAGE
TiboRex Absolute should be stored in unopened and undamaged original packaging.
In this state, depending on the application and the storage conditions, the extinguishing agent may store conditions, the extinguishing agent can be stored for up to 10 years. This doesn't apply to firetubeX as a storage device due to its exposure to elements in hot areas. In this case the duration is equal to the product itself of 60 months.

ENVIRONMENT
When used as directed, TiboRex Absolute is physiologically safe and readily biodegradable.

SPECIAL INSTRUCTIONS
TiboRex Absolute is used undiluted. When used as intended, no health effects are expected.
Extinguishing exercises and tests should be coordinated with local authorities.

6. AFTER ACTIVATION
---CALL YOUR LOCAL FIRE DEPARTMENT---
The firetubeX is a quick suppressant. After an activation it is recommended to call the local fire department and assess the causes and safety procedures.

ELECTRICITY
It's recommended to shut down your main electricity hub. The suppressant agent is liquid, so it can flow into electrical appliances or equipment after being deployed.

CLEANING
After electricity shutdown, it's recommended to rinse the surfaces with a cloth and water.

DISPOSING
firetubeX is a one use only device. After activation, proceed to the discard of the equipment. It's not refillable or reusable.

7. DISPOSAL
The firetubeX system cannot be refilled and should be disposed of in accordance with local regulations after the end of its useful life or best-before date and if it has been activated.
As an alternative to disposal in accordance with communal regulations, the life cycle assessment of the product can be further improved if the firetubeX is disposed of in an ecological manner by an authorized partner after use or after expiry of the useful life or the best before date.

8. COMMISSIONING
ATTENTION!
If there is an extractor hood, the filter elements of the extractor

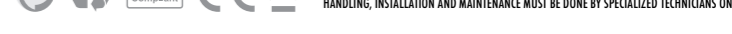
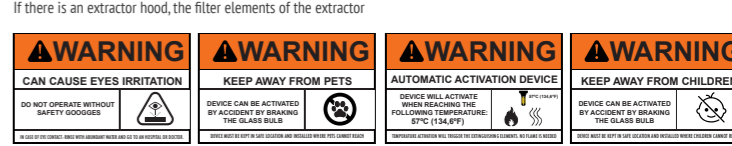

hood must be cleaned regularly or the filter mats replaced.
After installing and adjusting the firetubeX, you should always make sure that the system remains in its set position. In the event of a fire, carefully approach the stove and carefully remove the pot or pan from the hob and switch off the energy source immediately.
The extinguishing technology of the firetubeX is based on a thermo-pneumatic function. It is a self-sufficient system without any connection to an external energy supply.
After assembly, the protective cap is removed from the detection. The system is now ready for use.

9. CLEANING AND CARE
To ensure safe system operation, please follow these instructions and precautions.
CLEANING THE NOZZLE AND THE DETECTION MODULE
Check the detection module and the nozzle regularly for contamination. Soiling with grease, oil or dust can impair the function. If the detection module is dirty, clean it with a soap solution and a soft brush or cloth and remove the accumulated dirt. Do not use hard or pointed objects. This could damage the sensitive glass ampoule in the detection module. Improper handling will break the tube and trigger the system.

CLEANING THE NOZZLE
Make sure that the nozzle is not clogged with cooking or fat deposits. In case of contamination, clean the so that the nozzle opening is free. When cleaning, do not touch or damage the sensitive glass ampoule.

FUNCTION TEST
To ensure that the system is fully functional, a regular test (quarterly) must be carried out. To do this, press the alarm button. The red control lamp on the key switch flashes twice briefly. The system is functional.
Fault: If the battery voltage drops, the control lamp of the push button switch lights up twice for a long time when pressed. If the battery is almost completely discharged, an acoustic warning signal sounds.

10. TECHNICAL SPECIFICATIONS:
Dimensions
Length.....450mm
Diameter.....60mm
Weight.....3kg
Main components housing.....Stainless Steel
Extinguishing Agent Content.....900 ml
Spraying time.....aprox. 20 sec
Spray angle.....aprox. 90 degrees
Activation temperature.....57 degrees celsius
Activation System.....Thermo-bulb
Warning signal.....Piezo buzzer > 85 dBA
Battery.....2x Lithium Ion
Maintenance System care.....every year
Shelf life.....5 years

11. WARNINGS AND LIMITATIONS OF LIABILITY
Even if a protecfire product is employed, the end user must always use the cooker, oven and other objects possibly supervised by a protecfire product responsibly and safely.
The end user must constantly supervise their use. A protecfire product is not a substitute to and does not replace the fire alarms required by law and does not necessarily prevent fire or prevent or reduce any other damage and does not necessarily give an alarm of any damage or risk thereof. The end user must always take care of fire safety as set forth in regulations. A protecfire product must be used according to its user manual.
protecfire products do not diminish or remove the end users responsibility to follow the applicable regulations or authorities orders or the responsibility to act with due care to avoid damage to property and persons.
The end user is responsible for maintaining in force its insurances for property and persons. protecfire shall not be liable for any damage to property or persons or for any monetary or financial damages caused by the functioning or non-functioning of a protecfire product, to the extent the mandatory law allows this kind of disclaimer.

